



2 of 3 – Unused – 2014 Case 885B VHP



# Houston, TX

November 6–7, 2018 (Tue–Wed)

Unreserved public auction



2012 John Deere 470G LC



2 – 2015 Case IH Steiger 580S



McCloskey C50 25 x 50 in.



2016 Peterbilt 367 & 2 – 2016 Peterbilt 365



2 – Grove RT765E2 65 Ton

ACCEPTING CONSIGNMENTS, CONTACT US NOW

[rbauction.com/Houston](http://rbauction.com/Houston)

# Houston, TX

November 6–7, 2018

Tue–Wed 8:00 am

Phone: **713.455.5200**

Fax: 713.455.5270

Auction location: 15500 Eastex Frwy,  
Humble, TX, 77396

## 2,340+ items & counting

Bid in person or online

On-site registration starts: Nov 4 (Sun)

Inspection hours: Mon–Fri, 8 am–5 pm

Items must be removed by: Nov 21 (Wed)

Auctioneer Chad M. Johnson #17668

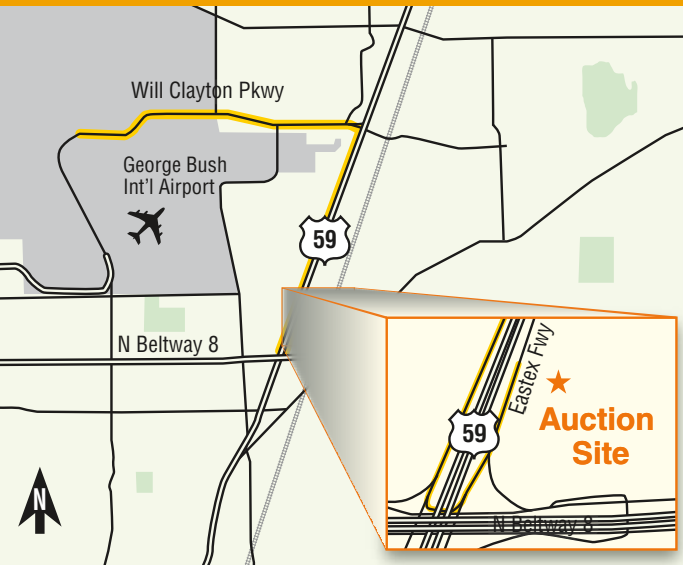

### Car rentals

Take advantage of exclusive rental car discounts.

**AVIS code:** C039702 | **Budget code:** A062002

### Auction highlights

Equipment from:

**Putzmeister**  
**Bechtel**



and other owners

Visit [rbauction.com](http://rbauction.com) for complete auction information

- Full equipment listings, more photos and detailed equipment information
- New additions to each auction – items added daily!
- Deposit and payment information, including financing, wire transfer accounts and taxes
- Full auction schedule, with times and lot numbers
- Maps, hotels and other local services

### Auction notes

- ▶ Every item is sold 'as is, where is'
- ▶ International and online bidders – you may need to place a refundable deposit before you bid – check the auction details on our website for more information
- ▶ Transaction fee: (a) 10% on all lots selling for \$5,000 or less, (b) 3.85% on all lots selling for over \$5,000 up to \$33,500, with a minimum fee of \$500 per lot or, (c) \$1,290 on all lots selling over \$33,500.

### Directions to auction site

**From 59 coming from the North:** Exit Beltway 8 Frontage road exit, U-turn, stay on feeder to customer entrance. Deliveries turn right on Bender Rd just past customer entrance.

**From 59 coming from the South:** Exit Greens Rd. Customer entrance immediately on the right, deliveries just past customer entrance at Bender Rd.

**From Beltway 8 coming from the East:** Stay on Beltway 8 Frontage road to 59N feeder. Follow to customer entrance. Deliveries to Bender Rd just past customer entrance.

**From Beltway 8 coming from the West:** Exit Lee Rd to 59N feeder to customer entrance, deliveries to Bender Rd just past customer entrance.

### Please note:

At Ritchie Bros., our commitment to safety is unreserved. Buyers and sellers are responsible for arranging the unloading and loading items which exceed the capacity or safe-lifting ability of Ritchie Bros' forklifts and loaders, operating as a single machine.

# BID & BUY ON THE GO!



Download the Ritchie Bros. app today.

[rbauction.com/app](http://rbauction.com/app)



It's back for a limited time only

# NO PAYMENTS FOR 120 DAYS\*

Apply today

\*OAC. Terms and conditions apply.

Call 1.855.331.7237 or visit [rbauction.com/Flex](http://rbauction.com/Flex)



Caterpillar 583K



Caterpillar 583H



Caterpillar D7G



Caterpillar D6D LGP



2009 Caterpillar D8T



2013 Caterpillar D6T LGP



Caterpillar D6T LGP



2012 Caterpillar D6K LGP



John Deere 850J LGP



Komatsu D61P-12



2017 Caterpillar 950M



1 of 2 - 2017 Caterpillar 938M



Caterpillar 928GZ



Komatsu WA500-6



2016 Bobcat S750



2014 Case SV250



2013 Bobcat T770



2014 Case TV380



2015 Caterpillar 279D 2 Spd



Case TR270



2014 Caterpillar 730C w/N600



2015 John Deere 872GP AWD



Caterpillar 345DL



1 of 2 – 2011 Caterpillar 329DL



2014 Caterpillar 320EL



Caterpillar 320CL



2011 Caterpillar 336EL



John Deere 350G LC



2014 Link-Belt 145X3



2012 Volvo EC340DL – Hammer sold separately



2014 Volvo EC250DL



1 of 2 – 2015 Bobcat E50



2017 Bobcat E42



1 of 2 – 2016 Bobcat E35



John Deere 270D LC



2014 Case 580N



Grove GMK5130



Grove GMK5120



2009 Terex RT1120 120 Ton 4x4x4



1 of 4 - Galion 150FA



Grove RT600E 50 Ton



Grove RT530E-2 30 Ton



Grove RT530E 30 Ton



Link-Belt RTC80100 100 Ton 6x6



2013 Link-Belt RTC8030-2



2009 Link-Belt RTC8030 Series 2 30 Ton 4x4x4



2009 Link-Belt RTC8030 30 Ton



Tadano TR650XXL



Tadano TR650XXL



Tadano TR600XL



2011 Terex RT780 80 Ton



1 of 4 – 2013 Terex RT670-170 Ton



2011 Terex RT555-155 Ton



Grove RMS700B 50 Ton 8x4x4



Link-Belt HTC8660 60 Ton 8x4x4



Link-Belt HTC8650 50 Ton 8x4x4



Terex T340-140 Ton 6x4



2 – Mantis 9010 45 Ton



2012 Shuttlelift 3330FL 8.5 Ton



Blaw-Knox PF5510



2013 Bomag MPH364R-2



2 – Caterpillar RM350B



2015 Roadtec SX-2E



Hydro-Ax 670



Barko 295ML



Timberjack 648H





Eagle 33D5170 Impact



Extex 5000



Komatsu HM400



2 of 5 - 2013 & 2015 JLG A943 9000 Lb



Hyster H450HD 39200 Lb



2012 Kalmar DCE160-12 36000 Lb



Kalmar DCE160-12 36000 Lb



1 of 5 - JLG 800AJ



Beechcraft B60 Duke



1 of 2 – 2015 John Deere 9560R Scraper Special



1 of 2 – 2015 John Deere 9520R



Rome 8TAH1628



2 of 4 – Reynolds 14C



International 8100



Ford 8000 w/Atlantic Equipment MCD353 37 Ft Mast

## Equipment listings

### Construction

**PIPELAYERS:** Caterpillar 583K • Caterpillar 583H Crawler • Caterpillar 571D7G Crawler • Caterpillar D7G • Caterpillar D7G Crawler • Caterpillar D6D.

**15- CRAWLER TRACTORS:** Case 1550 • Caterpillar D10 • 2009 Caterpillar D8T • Caterpillar D8H • 2013 Caterpillar D6T LGP • Caterpillar D6T • Caterpillar D6RXW • Caterpillar D6K LGP • Fiat-Allis 11B • John Deere 850J LGP • John Deere 450G LGP • 2- 2013 Komatsu D65PX-17 LGP • Komatsu D61P-12 Avance LGP • Komatsu D37PX-21.

**21- WHEEL LOADERS:** Case 821C • Unused- 2017 Case 621G • 2017 Case 621G • 2017 Caterpillar 950M • 2- 2017 Caterpillar 938M • 2- Caterpillar 938F • Caterpillar 928GZ • Caterpillar 914G • Fiatallis 745 • Fiatallis 545B • 2- Furukawa FL230 • John Deere 624J • Komatsu WA500-6 • Komatsu WA500-3L • Komatsu WA320-6 • Komatsu WA180-3PT • Komatsu WA180-1 • Volvo L90C.

**CRAWLER LOADERS:** 2- Caterpillar 977L.

**16- SKID STEER LOADERS:** Bobcat 753 • 2016 & 2014 Bobcat S750 • 2012 Bobcat S650 • Bobcat S185 • 2- Bobcat S160 • 2009 Case 430 • 2011 Case SR250 2 Spd • Caterpillar 268B 2 Spd High Flow • Caterpillar 262C • Caterpillar 226B • Gehl 4835SXT • 2013 John Deere 323D • John Deere 270 Series II • 2015 Kubota SSV65.

**20- MULTI TERRAIN LOADERS:** 2013 Bobcat T770 2 Spd High Flow Compact Track • 2016 Bobcat T750 Compact Track • 2017 Bobcat T650 High Flow Compact Track • 2016 & 2013 Bobcat T590 Compact Track • Bobcat T300 Compact Track • 2- Bobcat T250 • 2012 Bobcat T180 Compact Track • Caterpillar 287B • 2015 Caterpillar 279D 2 Spd High Flow Compact Track • 2014 Caterpillar 259D Compact Track • 2- JCB 320T Compact Track • Takeuchi TL120 Compact Track • 2014 Terex PT110F 2 Spd High Flow Compact Track • 4- Terex PT30 Compact Track.

**MOTOR GRADERS:** Austin-Western 300 • 3- Unused - 2014 Case 885B VHP • Caterpillar 130G MIL • Caterpillar 12H • 2015 John Deere 872GP AWD • John Deere 570A.

**26- HYDRAULIC EXCAVATORS:** Caterpillar 345DL • 2- 2011 Caterpillar 329DL • Caterpillar 320L Long Reach • 2014 Caterpillar 320EL • 2- Caterpillar 320CL • Fiatallis FX350 Phoenix Series • 2012 Hyundai Robex 210LC-9 • John Deere 690E Long Reach • 2012 John Deere 470G LC • 2014 John Deere 350G LC • John Deere 270D LC • 2012 John Deere 210G LC • 2- John Deere 200C LC • John Deere 120C • Kobelco SK330LC • 2012 Komatsu PC490LC-10 • Link-Belt LS2700C Series II • Link-Belt 160LX

• New Holland EC240 • 2012 Volvo EC340DL • 2012 Volvo EC300DL • 2014 Volvo EC250DL • 2012 Volvo EC220DL.

**MOBILE EXCAVATORS:** Gradall XL3100.

**MIDI EXCAVATORS:** 2015 & 2- 2014 Bobcat E50 • Komatsu PC128US-1 • 2012 Volvo EC55C.

**26- MINI EXCAVATORS:** Bobcat 331 • 2011 Bobcat 324M • 2012 Bobcat E55 • 2016 & 2015 Bobcat E50 • 2015 Bobcat E42R • 2017 & 2- 2015 Bobcat E42 • 2- 2016 & 2- 2015 Bobcat E35 • Caterpillar 304 • 2013 John Deere 35D • Kubota K0083 • 2012 Kubota KX41-3 • 3- 2015 Kubota KX018-4 • 2- Kubota K008T4 • Kubota K008-3 • Kubota • 2014 Terex TC16 • 2012 Volvo EC35.

**ARTICULATED DUMP TRUCKS:** Terex TA30 • 2014 Volvo A40G 6x6.

**17- TRENCHERS:** 6- Barreto E924HM-4MS • Ditch Witch 1030 Walk Behind • 2014 Ditch Witch RT45 • 2014 & 2013 Ditch Witch RT30 • Toro TRX20 • 3- Toro TRX20 Walk Behind Crawler • Vermeer V8550A 4x4 • Vermeer T655 • Vermeer TR350.

**DIRECTIONAL DRILLS:** 2013 Ditch Witch JT1220 Mach 1 Crawler • 2014 Ditch Witch JT20 Crawler.

**19- LOADER BACKHOES:** Allmand Bros. TLB6235ESL 4x4 • Case 580SM 4x4 • Case 580SL 4x4 • 2011 Case 580N 4x4 • Case 580M • Case 580M 4x4 • 2011 Caterpillar 420E IT 4x4 • Fercmec 750 • John Deere 310SJ 4x4 • John Deere 310K 4x4 • 2012 John Deere 310J 4x4 • 2- 2012 John Deere 310J • John Deere 310G • John Deere 310E 4x4 • 2016 Kubota L47 • Kubota BX25DLB • Kubota BX25D 4x4 • Terex TX760B 4x4.

**ALL TERRAIN CRANES:** Grove GMK5130 • Grove GMK5120.

**29- ROUGH TERRAIN CRANES:** Galion 150FA 15 Ton • 4- Galion 150FA • 2- Grove RT860 • Grove RT765E2 65 Ton 4x4 • Grove RT765E2 65 Ton 4x4 w/Rear Steer • Grove RT600E 50 Ton • Grove RT530E-2 30 Ton 4x4 w/Rear Steer • Grove RT530E • Grove RT528C 28 Ton 4x4 • Link-Belt RTC80100 100 Ton 6x6x6 • Link-Belt HSP8060 • 2013 Link-Belt RTC8030 30 Ton • 2009 Link-Belt RTC8030 Series 2 30 Ton 4x4x4 • Link-Belt HSP22 22 Ton 4x4x4 • 2- Tadano TR650XXL 65 Ton 4x4x4 • Tadano TR600XL 60 Ton 4x4x4 • 2009 Terex RT1120 120 Ton 4x4x4 • 2011 Terex RT780 • 4- 2013 Terex RT670 70 Ton 4x4x4 • 2011 Terex RT555-1.

**HYDRAULIC TRUCK CRANES:** Grove TMS700B 50 Ton 8x4x4 • Link-Belt HTC8660 60 Ton 8x4x4 • Link-Belt HTC8650 50 Ton 8x4x4 • Terex T340-1 40 Ton 6x4 • Terex.

**CRAWLER CRANES:** 2- Mantis 9010 45 Ton.

**CRANES:** 2009 Broderson IC803H 9 Ton 4x4 Carry Deck • Broderson IC803G Carry Deck • 2012 Broderson IC200-3G 15 Ton 4x4x4 Carry Deck • 2012 Shuttlelift CD3330FL 8.5 Ton Carry Deck • Qty Of Wright 6 Ton Overhead.

**VIBRATORY PADFOOT COMPACTORS:** Caterpillar CP433C • Champion Superpac 540P.

**VIBRATORY SMOOTH DRUM ROLLERS:** 2015 Bomag BW211D50 • Ingersoll-Rand SD100 • Ingersoll-Rand SD70D • Wacker RD12A Tandem.

**14- TANDEM ROLLERS:** Bomag BW141AD-2 • Unused - Roadway TYL42A Vibratory • 12- Unused - 2018 Storike ST1000 Vibratory.

**ROLLERS:** Ingersoll-Rand PR125R 9 Wheel.

**WALK BEHIND COMPACTORS:** 2015 Atlas Copco LT6004 Plate • 2014 Wacker BS604S Plate • Qty Of Mikasa MTX60HD Jumping Jacks • Qty Of Mikasa Plate • Qty Of Mikasa MVC88VTHW Plate • Qty Of Mikasa MVC90H Plate • Qty Of Mikasa MTX60HD Jumping Jacks.

**ASPHALT PAVERS:** Barber-Greene SB131 Pneumatic • Blaw-Knox PF5510 • Mauldin 1750C Super Pav.

**PAVEMENT PROFILERS:** Wirtgen W2100.

**ASPHALT EQUIPMENT:** Graco Road Lazer Striper.

**CONCRETE PAVERS:** Gomaco GP2500 Crawler.

**PULVERIZERS & MIXERS:** 2013 Bomag MPH364R-2 Pulvimixer • 2- Caterpillar RM350B Soil Stabilizer • 2015 Roadtec SX-2E Soil Stabilizer.

**FELLER BUNCHERS:** Hydro-Ax 670 Rubber-Tired.

**SKIDDERS:** Timberjack 648H 4x4 Grapple.

**ENVIRONMENTAL EQUIPMENT:** Bandit 150 Wood Chipper • Morbark Eagle Beaver 29 Wood Chipper • 2010 Vermeer BC1000XL Chipper • Vermeer BC1000XL Wood Chipper • Portable Air Curtain Burner.

**JAW CRUSHERS:** McCloskey C50 25 x 50 In.

**IMPACT CRUSHERS:** Eagle 33D5170 Portable.

**SCREEN PLANTS:** Extac 5000 6 x 17 Ft 2 Deck Portable • Powerscreen Powergrid 800 Portable.

**FEEDERS:** 2018 Suihe 5 x 7 Ft Grizzly.

**CONVEYORS:** Portable • 4- Unused - 2018 Better BE3660C 36 In. x 60 Ft Portable Radial Stacking • Unused - 2018 XCG 36 In. x 60 Ft Portable • 3- Unused - 2018 XCG 36 In. x 60 Ft Portable Radial Stacking.

**AGGREGATE EQUIPMENT:** 2010 Cemen Tech MCD10-150 Portable Batcher • 3- Unused - 2018 Paladin Permanent Suspended Magnet.

## Other items of interest

**23- TELESCOPIC FORKLIFTS:** Caterpillar TH360B • 5- 2014 & 2012 Genie GTH1056 10000 Lb 4x4x4 • 2- Genie GTH1056 10000 Lb 4x4x4 • 4- 2014 & 2012 Genie GTH844 8000 Lb 4x4x4 • 2012 JCB 50942 9000 Lb 4x4x4 • 2013 JLG G1055A 10000 Lb 4x4x4 • 5- 2015 & 2013 JLG G943A 9000 Lb 4x4x4 • Lull 1044C54 Highlander 10000 Lb 4x4x4.

Reminder: Don't wait until...  
Opened at 9:25 AM:  
2013 Cat 349EL Track Excavator KS 876880 2013 Kenworth T660 Bidding closes in: 2 min, 37 sec\* (extended) Highest bid US \$152,000 Bid US \$153,000  
2013 Kenworth T660 Highest bid US \$35,000 36 bids  
Opened at 9:30 AM:  
Terex T560 Hydraulic Truck Crane TX 755918 2008 Prentice Winning bid US \$105,460  
2008 Prentice Highest bid US \$71,150  
Opened at 9:35 AM:  
2008 Cat 12M Motor Grader AZ 863858 Bidding closes in: 3 min, 37 seconds\* Highest bid US \$61,000 Bid US \$62,000  
2012 Cat Highest bid US \$71,150  
2011 International 4300 Cab & Chassis NC 876883 2013 Kenworth Bidding closes in: 3 min, 37 seconds\* Highest bid US \$11,500 Bid US \$12,000  
2013 Kenworth Highest bid US \$2,190

# Explore More Equipment

Check IronPlanet's weekly online equipment auctions

[ironplanet.com](http://ironplanet.com)

**IRON PLANET**

**ROUGH TERRAIN FORKLIFTS:** 2011 Case 586G • 2009 Case 586G 6000 Lb • John Deere 482C 6000 Lb • Pettibone 154B 15000 Lb.

**34- FORKLIFTS:** Baumann 6000 Lb • Caterpillar GP25 • 3- 2012 Doosan D25S5 • Hyster H450HD 39200 Lb • Hyster H300B 34000 Lb • Hyster H100XL 10000 Lb • Hyster H60XLM 6000 Lb • Hyster H40XL 4000 Lb • Hyster • 2012 Kalmar DCE160-12 • Kalmar DCE160-12 36000 Lb • Linde H70D-02 10000 Lb • Linde H20CD60003 • 10- 2009 Mitsubishi FGC20N 4000 Lb • Moffett M5500 Pallet Truck • 2- Moffett M5000 Pallet Truck • TCM FD40T9 8600 Lb • 2012 Toyota 8FGU25 • 4- 2010 Toyota 7FGU35 7000 Lb.

**ELECTRIC FORKLIFTS:** Caterpillar DP50K • Hyster J30XMT 3000 Lb • Yale GP155CA.

**77- SCISSORLIFTS:** Genie GS4390 4x4 Rough Terrain • Genie GS3268RT 4x4 • Genie GS3268RT 4x4 Rough Terrain • 2- Genie GS3246 • 2011 Genie GS3232 Electric • 2- 2011 Genie GS2646 Electric • 2011 Genie GS2032 Electric • Genie GS2032 Electric • 2012 Haulotte 2747E • 2- 2011 JLG 4069LE Electric • 2011 JLG 3246ES Electric • 2- 2011 JLG 2646ES Electric • 3- 2011 JLG 2630ES Electric • 2- 2011 JLG 2030ES Electric • JLG 2030ES • JLG 33RTS • JLG 33RT 4x4 • 2- 2011, 24- 2010 & 4- 2009 JLG 20MVL Electric • Skyjack 8831F • Skyjack SJIII4632 Electric • 2- Skyjack SJIII4632 • 2011 Skyjack SJIII4626 Electric • 2012 Skyjack SJIII3226 Electric • 5- Skyjack SJIII3226 Electric • 11- Skyjack SJIII3226 • 2011 Skyjack SJIII3219 Electric.

**67- BOOM LIFTS:** 2- Bil-Jax XLT1571 • 2- 2014 & 2013 Genie Z80/60 4x4x4 Articulated • 2013 Genie Z80 4x4x4 Articulated • Genie S80 4x4 • 3- Genie S-65 • Genie Z60/34 4x4 Articulated • 2012 Genie Z60 • Genie TZ50 Electric Tow Behind Articulated • 2- Genie Z45/25 4x4 Articulated • Genie Z45/22RG • 2012 Genie Z45 • Genie Z40/23N RJ Electric Articulated • 3- Genie S-40 • Genie S40 • Genie S40 4x4 • Genie Z34/22N Electric Articulated • Genie Z30/20N Electric Articulated • 2011 Genie AWP-30SAC Personnel Lift • 2010 & 2009 Genie GR20 Electric Personnel Lift • 4- 2010 & 2009 Genie GR15 Personnel Lift • 2013 & 2012 JLG 800AJ 4x4x4 Articulated • JLG 600S 4x4 • 2011 JLG 600AJ 4x4x4 Articulated • 2011 JLG 600AJ Articulated • JLG 600AJ • JLG 450AJ • JLG 450A 4x4 Articulated • 5- JLG 400S 4x4 • 2009 JLG E400AJPN Electric • JLG E400AJPN Electric • JLG 120SXJ • 2010 JLG 20MVL Electric Personnel Lift • 2011 JLG 15MVL Electric Personnel Lift • 2- 2009 JLG 12SP Electric Personnel Lift • 3- JLG 12SP Electric Personnel Lift • 2- 2013 Skyjack SJ63AJ • 2013 Skyjack SJ61T • 2014 Skyjack SJ46AJ 4x4 Articulated • 2- 2014 & 2013 Skyjack SJ46AJ • 2013 Skyjack SJ46AJ 4x4 Articulated • 2013 Skyjack SJ40T 4x4 • 2- 2013 Skyjack SJ40T.

**4WD AGRICULTURAL TRACTORS:** 2- 2015 Case IH Steiger 580S • 2- 2014 John Deere 9560R Scraper Special • 2- 2015 John

Deere 9520R Scraper Special • John Deere 9220 • 2013 Kubota MX5100.

**MFWD AGRICULTURAL TRACTORS:** Ford 7710 • 2011 New Holland Workmaster 75 • New Holland.

**2WD AGRICULTURAL TRACTORS:** John Deere 5220.

**DISCS:** Rome 8TAH1628.

**PULL SCRAPERS:** 2- Reynolds 14C • 2- Reynolds.

**UTILITY CARTS:** 7- 2011 Bobcat 3400D • 2014 Club Car XRT 950 2X4 G • 2- 2015 Kubota RTV1140CPX 4x4.

**SEWER & WATER:** Qty Of Trench Boxes • Qty Of 7 In. x 7 Ft Spacers.

**BROOMS:** 2- Broce RJ350 • Broce BB250C.

**STREET SWEEPERS:** 2012 Elgin Crosswind J340D S/A Business Class M2 • Ford CF8000 COE S/A • Tennant 6600.

**RECREATIONAL VEHICLES:** Newell Motor Home.

**DRILLS:** Atlantic Equipment AD150C 80 Ft Digger • Atlantic Equipment AD150C Crawler • Ford 8000 Truck Mounted T/A Drill Truck • International 8100 Drill Truck • Texoma S Econo 12 4x4 Swamp Buggy.

**68- AIR COMPRESSORS:** 2012 Atlas Copco XAS750JDT3 Portable • 2010 Atlas Copco XAS750CD6 Portable • 2- 2011 Atlas Copco XAS375JD6 Portable • 2010 Atlas Copco XAS375JD6 • 2010 Atlas Copco XAS375 Portable • 10- 2015 Atlas Copco XAS185KD Portable • 2010 Atlas Copco XAS185JDU7 • 2- 2012 & 2- 2011 Atlas Copco XAS185JDHH Portable • Atlas Copco XAS90JD Portable • 2014 Chicago Pneumatic CPS400150JD • 2014 Chicago Pneumatic CPS400100JD Portable • 3- 2013 Chicago Pneumatic CPS400100CUD Portable • 2014 & 6- 2013 Chicago Pneumatic CPS400CUD Portable • 2013 Chicago Pneumatic CPS400-100 Portable • 2013 & 2012 Chicago Pneumatic CPS375PD Portable • 22- 2013 & 2011 Chicago Pneumatic CPS185DD Portable • 2011 Doosan HP375WJD Portable • 2013 Doosan O185WKUBT4Z • Ingersoll-Rand P375WCU Skid Mounted • Sullair 375JD Portable • Sullair 185DPQJD • Sullair 185DPQ Portable • Sullivan D185011JD Portable • 2011 Sullivan D375PDXJD.

**INDUSTRIAL GENERATOR SETS:** Portable • Atlas Copco.

**GENERATOR SETS:** Caterpillar SR40 175 KW Portable.

**20- LIGHT GENERATOR SETS:** 2- 2013 Doosan G70 56 KW Portable • Ingersoll-Rand G80 64 KW Portable • Lima 60 Kw Skid Mounted • 2012 Magnum MMG100C 80 KW Portable • 4- 2012 Multiquip DCA70SSJU4i 56 KW Portable • 2- 2012 Multiquip DCA70SSJU4i 56 KW Portable • Multiquip DCA70SSJU 40 KW Portable • 2- 2011 Multiquip DCA70SSIU2 56 KW Portable • 2011 Multiquip DCA25USI2C 20 KW Portable • 2011 Multiquip DCA25USI2 20 KW Portable • 2- 2011 Wacker G100 80 KW Portable • 2011 Wacker G70 56 KW Portable • 2011 Wacker G25 20 KW Portable.

**78- LIGHT TOWERS:** 3- 2012, 7- 2011 & 7- 2010 Ingersoll-Rand LS-60HZ-T4F Portable • 2010 Ingersoll-Rand LS60HZ-T4F Portable • 2- 2010 Ingersoll-Rand LS60 Portable • 2012 Ingersoll-Rand Light Source 60 Portable • 2009 Magnum MLT4150M Portable • 2- 2011 Magnum MLT4060M Portable • Magnum MTL3060M Portable • 10- 2011 & 2010 Magnum MLT3060M Portable • Magnum MLT3060M Portable • 3- 2011 Magnum MLT3060K Portable • 2- 2010 Magnum Pro MLT3060 Portable • 27- 2011 & 2- 2010 Terex AL4000 Portable • 2015, 2014 & 5- 2013 Terex RL4 Portable.

**SIGN BOARDS:** Digco Portable Arrow Board.

**WELDERS:** 2- 2014 Lincoln Vantage 500 • 4- 2014 Lincoln Vantage 500 Portable • 2013 Lincoln Vantage 500 • 5- 2013 Lincoln Vantage 500 Portable • 4- Lincoln Vantage 500 Portable • 2015, 2014 & 2- 2013 Lincoln Vantage 400 Portable • Lincoln SAE400 Skid Mounted • 2- Lincoln 400 Portable • 2015 Lincoln Vantage 300 Portable • Lincoln SA200 Skid Mounted • Lincoln Portable • 2016 Miller Big Blue 800 Duo Pro SF Portable • 2013 Miller Big Blue 700 Duo Pro Portable • 2014 Miller Big Blue 400D Portable • 4- 2015 Miller Big Blue 400 Pro • 4- 2015 Miller Big Blue 400 Pro Portable • 2- 2014 Miller Big Blue 400 Pro • 6- 2014 Miller Big Blue 400 Pro Portable • Miller CP302 Electric • 2013 Miller Big Blue 300 • Miller Big Blue 251D Skid Mounted • Miller Bobcat 225 Skid Mounted • 13- Miller 200 • Qty Of Electric • Qty Of Welders.

**PUMPS:** Custombuilt Hydraulic Portable • 2- Eaton Hydraulic • 2- Gorman-Rupp 6 In. Self-Priming Portable Centrifugal • Honda 4 In. • MMD NPD6TDE 6 In. Portable Trash.

**AIRCRAFT:** Beechcraft Beechjet 400 N88UA 8 Seater Twin Engine • Beechcraft B60 Duke 6 Seater Twin Engine.

**CONCRETE EQUIPMENT:** 4- Cany Com SC75 Buggy • Gar-Bro 427R Bucket • Gar-Bro Bucket • 2018 Gwalker CNGV-2 Electric Vibrator • 4- Husqvarna Soff-Cut 4000 Walk Behind Saw • Unused - 2018 Loncin Power Trowel • 2- 2016 Multiquip GX340 Mortar Mixer • 2016 Multiquip WM90PH8 Mortar Mixer • 2015 Multiquip EM90SHS Mortar Mixer • 2018 Multiquip EM90SH8 Mortar Mixer • 2014 United Forms Corp Bridge Column Forms • Qty of 4 Ft Polymer Ground Boxes • Qty Of Mustang CV3500 Vibrators • Bucket.

**PIPELINE EQUIPMENT:** Mathey 4SA Bevel Machine • Ridgid Qty of 12R Die Heads • Qty Of Pipe Dollies.

**CONTAINERS:** 20 Ft Storage • 20 Ft Office • Qty of Unused - 1 CY Suihe Self Dumping Hoppers.

**ITEMS INCLUDE:** Drill Parts & Accessories • Crane Accessories • Equipment Attachments • Demolition & Recycling Attachments • Tractor Attachments • Industrial Items • Equipment Parts • Shop & Warehouse Items.



2 – 2016 Kenworth T880



2009 International 5900i PayStar



1 of 2 – Kenworth T800 w/Hiab 600



Liddell M80 80 Ton

Driving choice. 

# Unreserved public truck auction

Houston, TX | November 7, 2018 (Wednesday)



3 of 4 – 2015 Kenworth W900 Hot Oil – Low mileage



**Peterbilt 359 Winch**



**Freightliner FLD120**



**2013 International ProStar+**



**2012 Mack CXU613**



**2011 Peterbilt 389**



**2011 Peterbilt 388**



**2011 Peterbilt 387**



**2012 AM General M916 Winch**



**2011 Freightliner M2 Business Class**



3 of 7 – Western Star 4900FA w/Cottrell 9 Car



1 of 2 – 2014 Mack GU713



1 of 2 – 2014 Mack GU713



1 of 2 – 2016 Kenworth T880



1 of 2 – 2016 Mack GU713



1 of 2 – 2014 Mack GU713



Mack CHN613



2016 Mack GU713



Mack MR688S w/Schwing 52 Meter



2 - Mack MR688S w/Putzmeister 47 Meter



Mack MR688S w/Putzmeister 46 Meter



Mack MR688S w/Putzmeister 42 Meter



International 4900 w/Mat-3 BL.125.1



2011 Ford F550 w/IMT 3820 7500 Lb



2018 International 4300SBA



Mack CHN613 Winch



2015 Chevrolet 3500HD Service Utility



2015 Ford F550



Mack CL713



International 4400SBA Wireline



2011 International 4000 DuraStar



Trail King TK140HDG-62 2+3



Triflo Mud Mixing System



BSSE 60TAMM Sand King



## Equipment listings

**ASPHALT DISTRIBUTOR TRUCKS:** 4- 2015 Kenworth W900 T/A Hot Oil.

**WINCH TRACTORS:** 2012 AM General M916 6x6 • 2009 International 5900i Paystar Tri/A Heavy Haul • Kenworth T800 T/A • Mack RD690S T/A • Mack CHN613 T/A • Mack CH613 • Mack CH613 T/A.

**BED & RIG-UP TRUCKS:** Ford S/A Bed • Mack RD688S T/A Bed.

**TRUCK TRACTORS w/CRANE:** 2- Kenworth T800.

**114- TRUCK TRACTORS:** Capacity Terminal • 2012 Freightliner PX125064ST Cascadia Sleeper T/A • 2- 2012 Freightliner PX125064ST Cascadia Day Cab T/A • 2011, 2010 & 2- 2009 Freightliner PX125064ST Cascadia Sleeper T/A • Freightliner ST120064ST Century Class Sleeper T/A • 2- Freightliner D120064ST Day Cab T/A • 2009 Freightliner CL120064ST Columbia Sleeper T/A • 2012 Freightliner X12564ST Cascadia Day Cab T/A • 2012 Freightliner X12564ST Day Cab T/A • 2012 Freightliner X12564ST Sleeper T/A • 5- 2012 Freightliner X12564ST T/A • Freightliner M2106 S/A • Freightliner ST120 T/A • Freightliner FLD120 Day Cab T/A • Freightliner FLD120 Sleeper T/A • Freightliner Columbia Sleeper T/A • 2012 Freightliner Cascadia Cascadia T/A • 2013 Freightliner Cascadia T/A • Freightliner T/A • 4- International 9400I Sleeper T/A • International 9100I Day Cab T/A • International 8600 Day Cab T/A • International 4900 Day Cab S/A • International F2574 Day Cab T/A • 2- 2012 International ProStar+ 122 Eagle Sleeper T/A • 2011 International ProStar+ 122 Day Cab T/A • 2- 2011 International ProStar Sleeper T/A • 2009 International ProStar Premium Eagle Sleeper T/A • 2010 International ProStar Eagle Sleeper T/A • 2013 International ProStar Day Cab T/A • 2011 International ProStar Day Cab T/A • 2014 International ProStar+ Sleeper T/A • 2013 International ProStar+ Sleeper T/A • 2012 International ProStar+ Sleeper S/A • 2- 2012 International ProStar+ Sleeper T/A • 2- 2013 & 2- 2012 International ProStar+ Day Cab T/A • 2011 International ProStar S/A • 2012 & 2010 International ProStar T/A • 2013 International Paystar Day Cab T/A • 2013 International Sleeper T/A • 2012 International S/A • 2010 Kenworth T2000 Sleeper T/A • 2014 Kenworth W900L Sleeper T/A • Kenworth W900 Day Cab T/A • Kenworth W900 Sleeper T/A • 2009 Kenworth T800 Tri/A • Kenworth T800 Day Cab T/A • Kenworth T800 Quad/A Day Cab Tri/A • 2010 & 2009 Kenworth T660 Sleeper T/A • 2009 Mack GU713 Day Cab T/A • 2- Mack CV713 Day Cab Tri/A • Mack RD688S Day Cab T/A • 2013 & 2012 Mack CXU613 T/A • 2012 Mack CXU613 Sleeper T/A • Mack CX613 Vision Sleeper T/A • 2012 Mack CHU613 Day Cab T/A • Mack CHN613 T/A • Mack CH613 Day Cab T/A • Ottawa 30 Spotter • 2012 Peterbilt 587 Sleeper T/A • Glidered - 2015 & 2011 Peterbilt 389 Sleeper T/A • Peterbilt 389 Day Cab T/A • Peterbilt 389 Sleeper T/A • 2011 Peterbilt 388 Day Cab T/A • Peterbilt 388 Sleeper T/A • 2011 & 2010 Peterbilt 387 Sleeper T/A • 2009 Peterbilt 387 T/A • 2- 2009 Peterbilt 387 Sleeper T/A • 2- Peterbilt 387 Sleeper T/A • 2011 Peterbilt 386 Sleeper T/A • 3- Peterbilt 386 Sleeper T/A • Peterbilt 385 Day Cab T/A • 2013 Peterbilt 384 Sleeper T/A • 4- Peterbilt 379 Sleeper T/A • Peterbilt 378 Sleeper T/A • Peterbilt 377 T/A • Peterbilt 367 T/A • Peterbilt 367 Day Cab T/A • Sterling LT9522 Day Cab T/A • Volvo F12 Sleeper T/A • 2011 Volvo Sleeper T/A • 2013 Volvo Day Cab T/A • 2009 Western Star 4900SA Tri/A.

**12- CAR CARRIERS:** Peterbilt 379 T/A • Peterbilt 379 w/Cottrell T/A 9 Car • 2- Peterbilt 379 w/Boydston 9100ST T/A 9 Car Open • Sterling



Eager Beaver 35GHG 35 Ton



Holden HRD60 60 Ton



Siebert LBO-3-53T



2014 Transcraft TL2000 48 Ft



1 of 2 - 2016 Pitts LT40-8L



Riley Double Bunk Log & AMC Double Bunk



2017 Armorlite SBD40LT 40 Ft



CTS BDT40 40 Ft



2017 Travis 39 Ft



Vantage S85 Omega 37 Ft Quarter Frame

L9500 w/Corrtell T/A 10 Car • Volvo w/Cottrell T/A 9 Car Open • 6- Western Star 4900FA W/Cottrell T/A 9 Car.

**QUAD AXLE DUMP TRUCKS:** International 7600 • 2014 Mack GU713.

**26- DUMP TRUCKS:** 2011 Freightliner M2 Business Class T/A • Freightliner T/A • GMC C7500 S/A • International 8600 T/A • International 7400 T/A • International T/A • 2- 2016 Kenworth T880 Tri/A • 4- 2016 & 3- 2014 Mack GU713 Tri/A • Mack CHN613 Tri/A • Mack CH613 T/A • Peterbilt 379 T/A • 2016 Peterbilt 367 Tri/A • 2- 2016 Peterbilt 365 Tri/A • Sterling LT7500 T/A • Sterling T/A • 2015 Volvo VHD64F Tri/A • 2- 2016 Volvo VHD64F Tri/A.

**MIXER TRUCKS:** 2016 Mack GU813 Tri/A • Sterling LT8500 T/A.

**10- CONCRETE PUMP TRUCKS:** Mack MR688S 8x4 w/Putzmeister M42 • Mack MR688S T/A w/Putzmeister M28Z • 2- Mack MR688S COE 8x4 w/Putzmeister • Mack ME688S COE T/A w/Putzmeister BSF28Z.12L • 2- Mack w/Schwing • 3- Mack w/Putzmeister.

**14- WATER TRUCKS:** Ford B700 2000 Gallon • Freightliner FL112 • Freightliner FL70 2000 Gallon S/A • International 8600 2000 Gallon • International 7600 3000 Gallon T/A • 2013 & 2011 International 4400 4000 Gallon T/A • 2013 International 4300SBA Durastar 2000 Gallon S/A • 2012 & 2011 International 4300 2000 Gallon S/A • International 4300 2000 Gallon • International 2554 2000 Gallon S/A • Mack • Sterling LT9500 4400 Gallon T/A.

**DIGGER DERRICK TRUCKS:** Ford L8000 T/A w/Altec D900-47B C.

**BUCKET TRUCKS:** Ford F750 Extended Cab S/A w/Hi-Ranger TL41M • Ford F550 XL S/A w/Telelect HR37M • Ford F450 XL w/Versalift • GMC C7500 • GMC C7500 w/Altec LRV55 • 2- GMC C7500 S/A w/Altec LRV55 • International T/A w/Mat-3 BL.125.1 • Sterling Acterra.

**VACUUM TRUCKS:** 2015 Caterpillar CT660L Tri Drive Hydro Vac.

**FUEL & LUBE TRUCKS:** Ford F700.

**MECHANICS TRUCKS:** Dodge Ram 2500 • Ford 9500 Aeromax S/A • 2012 Ford F550 Service • 2012 & 2011 Ford F550 XL 4x4 • Ford F450 XL • Ford F350 Super Duty Service • 2009 GMC Sierra Extended Cab 4x4 Service • Peterbilt 330 S/A.

**11- REEFER TRUCKS:** Freightliner M2 Business Class S/A • 4- 2013 & 3- 2012 International 4300SBA Durastar S/A • 2013 International 4300 S/A DuraStar • 2012 International 4300 Durastar S/A • 2012 International Terrastar S/A.

**UTILITY TRUCKS:** 2013 Chevrolet 3500HD Extended Cab 4x4 • Chevrolet 2500HD • Ford F550 • 2012 Ford F350 XL Crew Cab • Ford F350 XL.

**17- VAN TRUCKS:** 2015 Chevrolet 3500HD Service Utility • Ford F550 XLT 4x4 • GMC C7500 • 2014 International 4300SBA Durastar S/A • 3- 2012 International 4300SBA DuraStar S/A • International 4300SBA S/A Cargo • 2012 International 4300 DuraStar S/A Cargo • 2012 International 4300 S/A Moving • 2- 2012 International 4300 DuraStar S/A • International 4300 • International 4200SBA S/A Cargo • International 4300 S/A • 2011 Isuzu NPR COE S/A • 2012 Mitsubishi Fuso S/A.

**SANITATION TRUCKS:** 2012 Freightliner M2 Business Class S/A Garbage Truck.

**ROLLOFF TRUCKS:** Ford LN8000 • 2- Peterbilt 379 T/A.

**CAB & CHASSIS TRUCKS:** International 7400 T/A • International 4700 • 2018 International 4300SBA S/A • Peterbilt 357 T/A.

**FLATBED TRUCKS w/CRANE:** International 1854.

**41- FLATBED TRUCKS:** Chevrolet C5500 S/A • Chevrolet 5500 Crew Cab • 2013, 2011 & 2010 Chevrolet 3500HD Crew Cab 4x4 • Chevrolet 3500 Crew Cab 4x4 • 2011 Dodge 3500 • 2016 Ford F750 • 2016 Ford F700 • 2009 Ford F650 • 2009 Ford F650 XL Crew Cab • Ford F650 Crew Cab Dually Crane • Ford F650 XL • 2- Ford F650 Crew Cab • 2015 Ford F550 Crew Cab • 2012 Ford F550 Crew Cab 4x4 • 2011 Ford F550 XL Crew Cab 4x4 • Ford F450 • 2015 Ford F350 XL Crew Cab 4x4 • 3- 2015 & 2014 Ford F350 XL Crew Cab • 2012 Ford F350 XL Crew Cab 4x4 • 2011 Ford F350 XL • Ford F350 Super Duty • Ford F350 XLT Dually • Ford Crew Cab • 2- Freightliner C120 • 2- Freightliner FLD T/A • GMC 7500 Crew Cab • International 9100I T/A • International 8600 T/A • International 8100 • International 4900 • 2013 International TerraStar S/A • Isuzu FSR • Mack CL713 T/A.

**TOW TRUCKS:** 2009 Chevrolet 3500 • 2013 Dodge 3500.

**11- TRUCKS:** Ford LS 8000F Grapple • Ford F750 S/A Reel • Freightliner M2 Business Class S/A Attenuator • GMC C6500 Chip • International 4900 Gas Bottle Distribution • International 4400SBA Extended Cab S/A Wireline • 2011 International 4000 DuraStar S/A Attenuator • Mack RD690S Pressure Pumping Kill • Mack RD688S Laydown • 2- Mack RD688S T/A Kill.

**SPORTS UTILITY VEHICLES:** 2011 Ford Escape • Jeep Wrangler 4x4.

**29- PICKUPS:** Chevrolet 3500HD • 2015 Chevrolet 2500HD Crew Cab 4x4 • 2013 Chevrolet 2500HD Extended Cab 4x4 • 2012 Chevrolet 2500HD Crew Cab 4x4 • 2012 Chevrolet 2500HD Extended Cab 4x4 • 2013 Chevrolet 1500 271 Extended Cab 4x4 • 2011 Chevrolet Silverado Extended Cab • 2010 Dodge 1500 • Ford F450 King Ranch Crew Cab Dually • Ford F350 • Ford F350 Extended Cab • Ford F350 XL Crew Cab • 2- 2015 Ford F250 XL Super Cab • 2011 Ford F250 Crew Cab 4x4 • 2- 2011 Ford F250 XL Crew Cab 4x4 • 2009 Ford F250 XL Extended Cab 4x4 • 2015 Ford F150 Lariat Crew Cab 4x4 • 2014 Ford F150 XL Super Cab • 2013 Ford F150 Extended Cab • 2012 Ford F150 XL Extended Cab • 2011 & 2009 Ford F150 • Ford F150 XL Extended Cab • 2- Ford F150 • Ford Ranger • 2011 Toyota Tundra Crew Cab 4x4.

**BUSES:** 2011 Ford E350 14 Passenger • Ford E350 20 Passenger • International 1753 42 Passenger S/A School • MCI D4500 54 Passenger T/A Coach • Optima LFB-34.

**11- AUTOMOBILES:** 2012 BMW 740Li • 2016 Cadillac CT6 Sedan • Ford Taurus • 2010 Honda Civic Sedan • 3- 2017 Nissan Altima Sedan • Toyota Avalon 5 Passenger Sedan • 2011 Toyota Camry Sedan • 2011 Toyota Camry • Volkswagen Beetle.

**17- LOWBOYS:** Custombuilt T/A Oilfield • Eager Beaver 35GHG 35 Ton T/A • Fontaine Tri/A • 2013 Fontaine • Holden HRD60 60 Ton Quad/A Oilfield • Holden HRD50 25 Ton Tri/A Oilfield • Liddell M80 80 Ton • Liddell • Loadcraft LDD340SFG Tri/A • 2009 Nuttall 350 • 2- Siebert LBO-3-53T • Trail King TK100MED482 • Trail King TK80MG492 Tri/A • Trail King TK60MG T/A • Trail King Tri/A • XL Specialized.

**11- STEP DECK TRAILERS:** Fontaine DFT78048WSAWK 53 Ft T/A Spread Axle • Fontaine DFT58053ASPWK 53 Ft T/A Spread Axle • HMD • Manac • Talbert T/A Spread Axle 50 Ft x 102 In. • Trail King TK70LCS532 53 Ft T/A Spread Axle • Transcraft DTL3000F3 53 Ft Tri/A • 2- 2016 Utility FS2CDHA 53 Ft T/A Spread Axle • 2015 Utility FS2CDHA 48 Ft T/A Spread Axle • XL Specialized XL90SDE T/A.

**35- HIBOYS:** 2016 Dorsey 48 Ft T/A • 2017 & 2016 Dorsey FB45 45 Ft T/A • 2016 Fontaine XTP5390S2 53 Ft T/A Extendable • Fontaine 48 Ft x 102 In. T/A • 2- Fontaine 48 Ft T/A • 2014 Fontaine HAVSF12SST 48

Ft T/A • Fruehauf 48 Ft x 96 In. T/A • Fruehauf 45 Ft x 102 In. T/A • 2014 Great Dane FSP002400048 48 Ft T/A Spread Axle • Great Dane 48 Ft x 96 In. T/A • Great Dane 45 Ft x 96 In. T/A • Lufkin 48 Ft T/A • Lufkin 42 Ft x 96 In. T/A • 2014 Transcraft TL2000 48 Ft T/A • Transcraft 48 Ft T/A • 5- Transcraft 45 Ft T/A • Transcraft Eagle 45 Ft T/A Spread Axle • 2012 Utility 48 Ft T/A • Utility 45 Ft T/A • 6- 2016 & 2- 2015 Utility FS2CHA 48 Ft T/A Spread Axle • 2015 Viking VFH48102T 48 Ft T/A • Wabash 48 Ft T/A.

**PNEUMATIC BULK TRAILERS:** Pullman 950 Cu Ft T/A.

**LOG TRAILERS & RIGGING:** AMC T/A Double Bunk • 2- 2016 Pitts LT408L 40 Ft T/A • Riley T/A Double Bunk.

**BOTTOM DUMP TRAILERS:** 2017 Armor Lite SBD40LT 40 Ft T/A • 2- Beall • CTS BDT40 40 Ft T/A • CTS • 2013 Manac 4B240AC00 40 Ft T/A • 2- Marquez.

**13- END DUMP TRAILERS:** Big Tex 10 Ft T/A • Clement LW3526BT 35 Ft T/A Frameless • CNC 32 Ft T/A Frameless • Unused - 2018 Double A 9620T10KGN 20 Ft T/A Gooseneck • Unused - 2018 Double A 8314TMD7K 14 Ft T/A Full Frame • Unused - 2018 Double A 8312TMD7K 12 Ft T/A Full Frame • Unused - 2018 Double A 7714TMD7KGN 14 Ft T/A Full Frame Gooseneck • Unused - 2018 Double A 7712TMD7K 12 Ft T/A Full Frame • Lufkin ULDDI38 T/A Frameless • SEI Pup Trailer • 2017 Travis 39 Ft T/A • Travis 38 Ft T/A • Vantage S85 Omega 37 Ft T/A Quarter Frame.

**SIDE DUMP TRAILERS:** Circle R TL 36 Ft Quad/A.

**REEFER TRAILERS:** 2012 Great Dane SUP1114 53 Ft T/A • Trailmobile 53 Ft T/A • 2011 Utility VS2RA 53 Ft T/A • Utility VS2R 48 Ft T/A • 2013 Wabash 53 Ft T/A • 2- Wabash 53 Ft T/A.

**19- VAN TRAILERS:** CM Enclosed • Great Dane 7311TR 53 Ft T/A • 12- Lufkin 53 Ft T/A • 2- Trailmobile • Utility 53 Ft T/A • Wabash 53 Ft T/A • WW Trailers T/A Enclosed.

**13- VACUUM TRAILERS:** Acro 166 Barrel T/A • Bourget T/A • 2- Dragon 130 Barrel T/A • Eagle EV13 130 Barrel T/A • Galyean 130 Barrel T/A • 3- Jack County 150 Barrel T/A • 2011 Jack County 130 Barrel T/A • Vactron 5000 Gallon Portable Hydro Vac Trailer • VE Enterprises FV130 130 Barrel T/A • VE Enterprises 130 Barrel T/A.

**TANK TRAILERS:** 2- Brenner 5000 Gallon T/A • 2011 Tiger GEL4000 • 2012 Tiger.

**64- EQUIPMENT TRAILERS:** Ameritrail GN40202 40 Ft T/A Gooseneck • 2013 Barreto E4X6TBT • 5- Barreto E4X6TBT • 2013 Belshe BF9T 18 Ft T/A • 2014 Better Built 19 Ft T/A • 2013 Big Tex 45SS 16 Ft T/A • 2013 Custombuilt 16 Ft T/A Utility • Custombuilt T/A • Diamond C 24 Ft T/A Gooseneck • Unused - 2018 Double A 10224T7GN 24 Ft T/A Gooseneck • Unused - 2018 Double A 8324TKGN 24 Ft T/A Gooseneck Utility • Unused - 2018 Double A 8320T7K 20 Ft T/A Utility • Unused - 2018 Double A 8318T7K 18 Ft T/A Utility • Unused - 2018 Double A 8318T 18 Ft T/A • Unused - 2018 Double A 8316T 16 Ft T/A Utility • Unused - 2018 Double A 8312T 12 Ft T/A Utility • Unused - 2018 Double A 7712S 12 Ft S/A Utility • 4- Unused - 2018 Double A 7210S 10 Ft S/A Utility • 2- Unused - 2018 Double A 6010S 10 Ft S/A Utility • Unused - 2018 Double A 6010EC 10 Ft S/A Utility • 2018 Double A 4808S 8 Ft S/A Utility • 2010 Dresen 16 Ft T/A • 2017 Hefty Utility • Keifer 30 Ft T/A • 4- MMDI 510RCMPH • 2012 MMDI ME510RCMPH 10 Ft T/A • 2011 MMDI ME47RVX9 7 Ft S/A • 2- 2014 MMDI 16 Ft T/A • Perkins 40 Ft T/A Gooseneck • Perkins 40 Ft

T/A • 2015 PJ Trailers FD322 32 Ft T/A Gooseneck • Pro Hauler 614SLTD • 4- Pro Hauler 47RVX9B • 4- Pro Hauler 47RVX9 • Southern States 20 Ft T/A Utility • 2013 Teske T22979 5 Ft S/A • 2- 2013 Teske 22979 5 Ft S/A • Teske 22979 • 2018 Texas Pride EQ72414KBP 20 x 8 Ft • 2016 & 2013 Top Hat 20 Ft Utility • Trailblazer Gooseneck • XLS T/A Flatbed • 510RCMPH.

**REEL TRAILERS:** 2015 Pro-Formance TR9250 T/A Gooseneck Spool.

**CONTAINER CHASSIS:** 2012 Doonan 532DCE1CCCECHZ 53 Ft Tri/A.

**TRAILERS:** Unused - 2018 Double A 4808S 8 Ft S/A Welding • 2009 Dragon TCT440 48 Ft T/A Spread Axle Rolloff • Dragon ST6 34 Ft T/A Rolloff • Dragon ST6 T/A Rolloff • Flow Boy 42 Ft T/A Live Bottom • Trailmobile 42 Ft T/A Refuse.

**35- MOBILE STRUCTURES:** Unused - 2018 Austin SPA2217S Portable Deluxe Restroom • Unused - 2018 Austin SST2213 Double Restroom • Unused - 2018 Austin SPA2212S Restroom • Unused - 2018 Austin SPA2020S Portable Deluxe Restroom • Unused - 2018 Austin SST1113 Restroom • Austin SST1113 3 x 4 Ft Portable Restroom • Morgan Building 08086GTYCUSD 8 Ft Office Trailer • Unused - 2018 Shin Kobe I I T2110C Double Restroom • Unused - 2018 Shin Kobe I I T1017C Restroom • 2- Unused - 2018 Suihe S408022DP PVC Double Trussed Storage Building • Unused - 2018 Suihe S408020R PE Dome Storage Building • Unused - 2018 Suihe S306515R PE Dome Storage Building • 2- Unused - 2018 Suihe 203012P PE Peak Storage Building • Unused - 2018 Suihe C4040 PE Dome Container Storage Building • Unused - 2018 Suihe C2040 PE Dome Container Storage Building • Unused - 2018 Suihe 10 x 7 Ft Portable Office • Unused - 2018 Suihe 6 x 7 Ft Portable Restroom • Unused - 2018 Suihe 4 x 7 Ft Portable Double Restroom • Suihe 6 x 7 Ft Portable Restroom • Suihe 3 x 7 Ft Portable Double Restroom • Unused - 2018 Suihe Portable Restroom • 2- Unused - 2018 Suihe Portable Restroom • Unused - TMG Industrial GLSR001 6 Ft 5 In. x 7 Ft 5 In. Portable • Unused - 70 x 30 x 16 Ft Commercial Grade Storage Building • Unused - 50 x 30 x 16 Ft Commercial Grade Storage Building • 46 x 10 Ft Office Trailer • 4- Unused - 40 x 24 x 14 Ft Storage Building • 2- Unused - 40 x 30 x 15 Ft Peak Ceiling Double Storage Building • 2- Unused - 30 x 40 x 7.2 Ft Container Storage Building • 9 x 7 Ft Skid Mounted Field Office • 4 x 7 Ft Portable Double Restroom.

**45- UTILITY CARTS:** 2014 Bobcat 3400XLG • 2012 Bobcat 3400XL • 2- 2013 Bobcat 3400XDSTD • 2013 Bobcat 3400GSTD • 2013 Bobcat 3400G • 2013 Bobcat 3400DXL • 2013 Bobcat 3400D • 2013 Bobcat 3400 • 3- 2013 Bobcat 3400 4x4 • 2013 Club Car 1550SE • 2014 John Deere 885E Gator 4x4 • 20- 2017, 2- 2013 & 2012 Kawasaki 4010 Mule 4x4 • 2013 Kawasaki 4010 • 2- 2015 Polaris Ranger 570 4x4 • 2014 Polaris 570 4x4 Ranger • 2012 Polaris 500EFI Ranger 4x4 Vehicle • 2015 Polaris Ranger 4x4 • 2016 & 2015 Polaris Ranger Crew 4x4.

**LOG LOADERS:** Barko 295ML Trailer Mounted.

**SCALES:** Unused - 10 Ton Platform Digital Floor • 5 Ton Platform.

**RECREATIONAL VEHICLES:** Ez Go ST Sport Golf Cart • 2011 Fairplay 2PEVE Electric Golf Cart.

**ITEMS INCLUDE:** Haying Equipment • Landscape & Livestock Equipment • Air Compressors • Generator Sets • Welders • Pumps • Tanks • Concrete Equipment • Pipeline Equipment • Containers • Industrial Plant Equipment • Engines • Drill Parts & Accessories • Crane Accessories • Truck Attachments • Industrial Items • Equipment Parts • Shop & Warehouse Items.

# KRUSE ENERGY AUCTIONEERS

A Ritchie Bros.™ solution

## OKLAHOMA CITY, OK

Oct 31 & Nov 1– 9am (CT)

Embassy Suites – Airport



Lufkin C640D



Tesco & FDS 250T Top Drives



2014 Western Star w/Cement



2014 UE MFG 1260 Dbl Pumper w/SPM 600S Triplexes

### Two-day oilfield equipment auction

#### Assets selling include:

- 11- drilling rigs
- 8- top drives
- Drill pipe & collars
- Trucks & trailers
- Well service rig & components
- Production & casing equipment
- Cranes

For details and bidding, visit [kruseenergy.com](http://kruseenergy.com) or call 432.563.2005

## Upcoming auctions around the world

### USA

Pittsburgh, PA	Oct 30
Salt Lake City, UT	Nov 5
Houston, TX	Nov 6–7
Lincoln, NE	Nov 9
Tipton, CA	Nov 13
Orlando, FL	Nov 13
Kenmare, ND	Nov 15
Flaxton, ND	Nov 16
Phoenix, AZ	Nov 16
Kansas City, MO	Dec 3
Sacramento, CA	Dec 4
Denver, CO	Dec 5
Atlanta, GA	Dec 6
Las Vegas, NV	Dec 7
Williston, ND	Dec 8
Columbus, OH	Dec 11
Fort Worth, TX	Dec 11–12
Chehalis, WA	Dec 13

### Canada

Brandon, MB	Oct 16
Edmonton, AB	Oct 23–26
Regina, SK	Nov 6
Truro, NS	Dec 7
Grande Prairie, AB	Nov 27–28

### International

Irvine, SCO	Oct 16
Northam, AUS	Oct 25
Narita, JPN	Oct 29
Donington Park	Nov 20–21



2 – Komatsu D65PX-17 LGP



Unused – 2017 Case 621G



2014 Volvo A40G 6x6



2 – 2016 Volvo VHD64F



2015 Caterpillar CT660L Tri-Drive Hydro Vac

See complete auction and equipment information on our website

[rbauction.com](http://rbauction.com)



Atlantic Equipment AD150C w/80 Ft Mast



Beechcraft Beechjet 400 N880A

Equipment videos, photos, auction news and more.  
Like us on [facebook.com/RitchieBros](https://facebook.com/RitchieBros)



Scan using your device's camera or a QR code reader.

Houston, TX | November 6–7, 2018 (Tue–Wed)

[rbauction.com](http://rbauction.com)

**rb RITCHIE BROS.**  
Auctioneers®

**60**  
YEARS